

NOTES

1. ALL DIMENSIONS ARE IN METRES UNLESS OTHERWISE STATED.
2. THIS DRAWING CONTAINS DATA BASED UPON ORDINANCE SURVEY MAPPING. REPRODUCED BY PERMISSION OF ORDINANCE SURVEY ON BEHALF OF HMSO. CROWN COPYRIGHT AND DATABASE RIGHT 2020. ALL RIGHTS RESERVED.
3. THIS DRAWING IS TO BE READ IN CONJUNCTION WITH ALL RELEVANT DOCUMENTS.
4. TSRGD REFERS TO TRAFFIC SIGNS REGULATIONS AND GENERAL DIRECTIONS 2016.

KEY

- EXISTING 20mph ROADS
- EXISTING 30mph ROADS
- PROPOSED 20mph ZONE ROADS
- PROPOSED 20mph ROADS

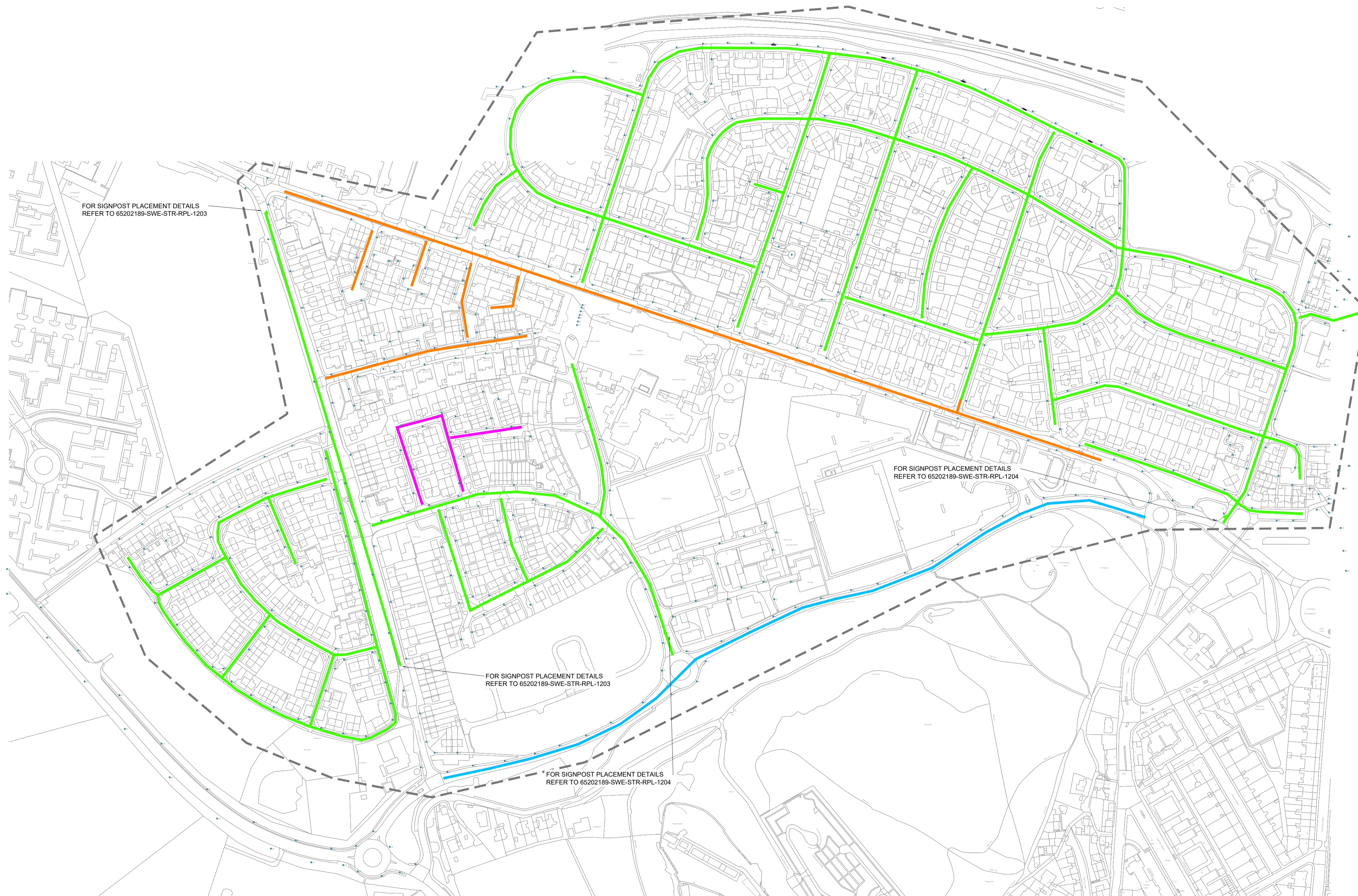

01	22.04.21	20mph ZONE ADDED	AMcN	CF	CF
Rev.	Date	Amendment Details	Drawn	Chk'd	App'd

This drawing should not be relied on or used in circumstances other than those for which it was originally prepared and for which Sweco UK Limited was commissioned. Sweco UK Limited accepts no responsibility for this drawing to any party other than the person by whom it was commissioned. Any party which breaches the provisions of this disclaimer shall indemnify Sweco UK Limited for all loss or damage arising therefrom.

Sweco
2nd Floor, Quay 2
139 Fountainbridge
Edinburgh
EH3 9QG
Tel: +44 (0)131 550 6300
Web: www.sweco.co.uk



Client
FOR CONSTRUCTION

Project Title
**STIRLING COUNCIL
SPACES FOR PEOPLE**

Drawing Title
**RAPLOCH
20mph SPEED LIMIT
LAYOUT**

Scale	Designed	Drawn	Checked	Approved
1:2500	AMcN	AMcN	CF	CF
Original Size	Date	Date	Date	Date
A1	05.02.21	05.02.21	16.03.21	16.03.21
Drawing Number	Revision			
65202189-SWE-STR-RPL-0101	01			