

The East Renfrewshire Council
(Glasgow Road / Gilmour Street, Eaglesham)
(Temporary Restriction to Use of Road)



Order 2019

On the 13 June 2019 East Renfrewshire Council made the above named Order under Section 14 of the Road Traffic Regulation Act 1984, as amended by the Road Traffic (Temporary Restrictions) Act 1991, in terms of which use of a section of the following road, by the undernoted classes of vehicle will be prohibited within the stated period of time.

(Note that the order will be in effect only when indicated by the display of appropriate signs in accordance with the Traffic Signs Regulations and General Directions 2016).

Effects of the Restrictions: TEMPORARY ROAD CLOSURE (GLASGOW ROAD, EAGLESHAM) AND VARIOUS JUNCTIONS CLOSURES (JUNCTIONS WITH GLASGOW ROAD AND GILMOUR STREET, EAGLESHAM)

Reason for the Restrictions: TO FACILITATE THE SAFE OPERATION OF ESSENTIAL CARRIAGEWAY RESURFACING WORKS SECTIONS OF GLASGOW ROAD AND GILMOUR STREET FROM AND INCLUDING THE JUNCTION OF HUMBIE ROAD TO THE JUNCTION OF MONTGOMERY STREET / CHEAPSIDE STREET.

Roads Restricted, Extents of Restriction and Alternative Routes:

PHASE 1:

GLASGOW ROAD – CLOSED FROM AND INCLUDING ITS JUNCTION WITH HUMBIE RD TO AND INCLUDING ITS JUNCTION WITH BALFEARN DR.
Alternative. Route: - EAGLESHAM ROAD – WATERFOOT ROAD – MEARNS ROAD – HUMBIE ROAD – BONNYTON DRIVE – POLEBAE CRESCENT – TARFF AVENUE AND VICE-VERSA

ALEXANDER AVENUE - CLOSED AT ITS JUNCTION WITH GLASGOW ROAD
Alternative. Route: - ALEXANDER AVENUE – HOLEHOUSE AVENUE – HOLEHOUSE ROAD GILMOUR STREET AND VICE-VERSA

HUMBIE ROAD - CLOSED AT ITS JUNCTION WITH GLASGOW ROAD
Alternative. Route: - HUMBIE ROAD – BONNYTON DRIVE – POLEBAE CRESCENT – TARFF AVENUE AND VICE-VERSA

BALFEARN DRIVE - CLOSED AT ITS JUNCTION WITH GLASGOW ROAD
Alternative. Route: - BALFEARN DRIVE – POLBAE CRESCENT – THEN FOLLOW MAIN DIVERSION ROUTE

PHASE 2:

HOLEHOUSE ROAD - CLOSED AT ITS JUNCTION WITH GLASGOW ROAD
Alternative. Route: - HOLEHOUSE ROAD – HOLEHOUSE AVENUE – ALEXANDER AVENUE – GLASGOW ROAD AND VICE-VERSA

TARFF AVENUE - CLOSED AT ITS JUNCTION WITH GLASGOW ROAD / GILMOUR STREET
Alternative. Route: - TARFF AVENUE – POLEBAE CRESCENT – BONNYTON DRIVE – HUMBIE ROAD – GLASGOW ROAD AND VICE-VERSA

AIRYLIGG DRIVE - CLOSED AT ITS JUNCTION WITH GILMOUR STREET
Alternative. Route: - AIRYLIGG DRIVE - POLEBAE CRESCENT – BONNYTON DRIVE – HUMBIE ROAD – GLASGOW ROAD AND VICE-VERSA

GILMOUR CRESCENT - CLOSED AT ITS JUNCTION WITH GILMOUR STREET
Alternative. Route: - GILMOUR CRESCENT – HOLEHOUSE ROAD – HOLEHOUSE AVENUE – ALEXANDER AVENUE – GLASGOW ROAD AND VICE-VERSA

PHASE 3:

POLNOON STREET - CLOSED AT ITS JUNCTION WITH GILMOUR STREET
Alternative. Route: - POLNOON STREET – MID ROAD – MONTGOMERY STREET AND VICE-VERSA

NOTE: THE ABOVE PHASES AND SCHEDULED CLOSURES ARE EXPECTED TO BE IN OPERATION FOR APPROXIMATELY 4 DAYS EACH BUT THIS WILL BE SUBJECT TO VARIATION DEPENDENT ON THE PROGRESS AND OPERATION OF THE WORKS – ALL ROAD CLOSURES AND ALTERNATIVE ROUTES WILL BE SIGNED ACCORDINGLY

Proposed Duration: THE TEMPORARY CLOSURES WILL BE IN EFFECT WHEN REQUIRED FROM 1st JULY UNTIL 12th JULY 2019 OR ON COMPLETION OF THE WORKS IF SOONER.

Max Duration of Restriction: THE ORDER WILL BE VALID FOR A MAXIMUM PERIOD OF 18 MONTHS AS PRESCRIBED BY LEGISLATION.

Classes of Vehicle Prohibited: ALL - EXCEPT VEHICLES ASSOCIATED WITH THE WORKS AND EMERGENCY VEHICLES ATTENDING AN INCIDENT. (NOTE: - ACCESS TO PROPERTIES WITHIN THE EXTENTS OF THE CLOSURE MAY BE PERMITTED BY THE CONTRACTOR ON SITE WHEN IT IS POSSIBLE TO DO SO IN CONJUNCTION WITH THE WORKS GOING ON AT THE TIME) PEDESTRIAN ACCESS WILL BE MAINTAINED AT ALL TIMES

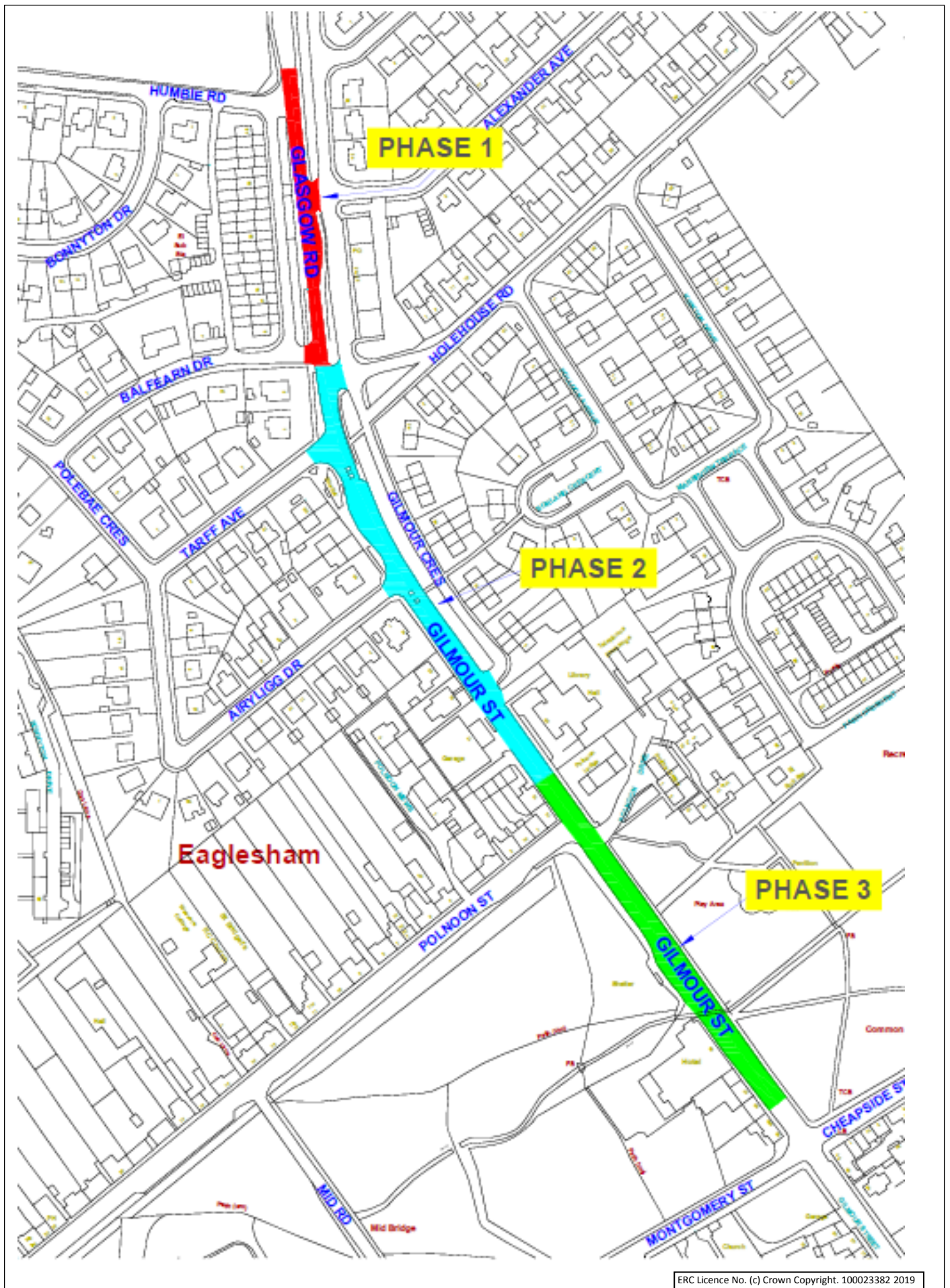

Approved:
 J Corrie
 Roads and Transportation Controller

Enquiries To:
roads@eastrenfrewshire.gov.uk