

ROAD TRAFFIC REGULATION ACT 1984: SECTION 14

EAST LOTHIAN COUNCIL HEREBY GIVE NOTICE UNDER SECTION 14(2) OF THE ROAD TRAFFIC REGULATION ACT 1984, AS AMENDED, THAT FOR THE REASON SET OUT IN SECTION 14(1)A OF THAT ACT THE FOLLOWING RESTRICTIONS WILL BE INTRODUCED:

MELBOURNE PLACE, NORTH BERWICK
CAR PARK
TTRO 034/24/R.McN

ROAD CLOSURE & SUSPENSION OF ONE-WAY TRAFFIC ORDER			
REASON	EXTENT	DURATION	
		FROM	TO
TO FACILITATE THE INSTALLATION OF A CARRIAGEWAY RAISED TABLE	<p style="text-align: center;">ROAD CLOSURE</p> <p>MELBOURNE PLACE FROM ITS JUNCTION WITH QUALITY STREET EASTWARDS FOR A DISTANCE OF 25m OR THEREBY</p> <p style="text-align: center;">SUSPENSION OF ONE-WAY SYSTEM</p> <p>MELBOURNE PLACE FROM NO.14 TO THE CAR PARK EXIT NEXT TO PUBLIC TOILETS, A DISTANCE OF 105m OR THEREBY</p>	<p>MONDAY 18th MARCH 2024</p> <p>TO</p> <p>THURSDAY 28th MARCH 2024</p>	

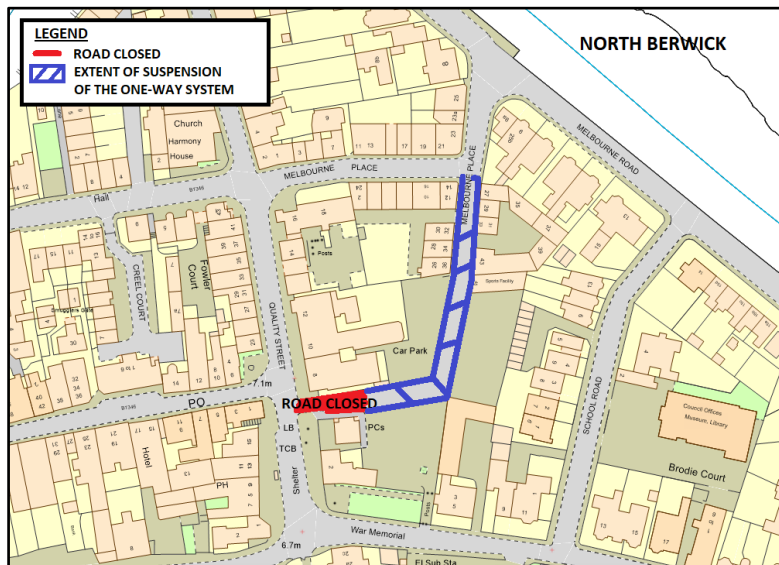

THIS NOTICE HAS A MAXIMUM DURATION OF 12 DAYS.



Alan Stubbs
Service Manager- Roads