

EAST LoTHIAN COUNCIL

**ROAD TRAFFIC REGULATION ACT 1984: SECTION 14
HIGH STREET / LINKFIELD ROAD, MUSSELBURGH**

THE EAST LoTHIAN COUNCIL HEREBY GIVE NOTICE UNDER SECTION 14(2) OF THE ROAD TRAFFIC REGULATION ACT 1984, AS AMENDED, THAT FOR THE REASON SET OUT IN SECTION 14(1)A OF THAT ACT AND TO ASSIST WITH TRAFFIC MANAGEMENT TO FACILITATE THE EDINBURGH TAXI TRADE OUTING, HIGH STREET AND LINKFIELD ROAD, MUSSELBURGH WILL BE CLOSED TO THROUGH TRAFFIC.

THE RESTRICTIONS ARE APPLICABLE FROM: -

10:00HRS TO 12:30HRS TUESDAY 11TH JUNE 2013

THE ALTERNATIVE ROUTE FOR EASTBOUND TRAFFIC SHALL BE BY WAY OF NEWBIGGING, PINKIE ROAD, ASHGROVE AND LINKFIELD ROAD AND THE REVERSE FOR WESTBOUND TRAFFIC.

PEDESTRIAN ACCESS SHALL BE MAINTAINED.

EMERGENCY VEHICLE ACCESS SHALL BE MAINTAINED.

THIS NOTICE HAS A MAXIMUM DURATION OF 2.5 HRS



S.A.BAXTER
SENIOR AREA NETWORK OFFICER



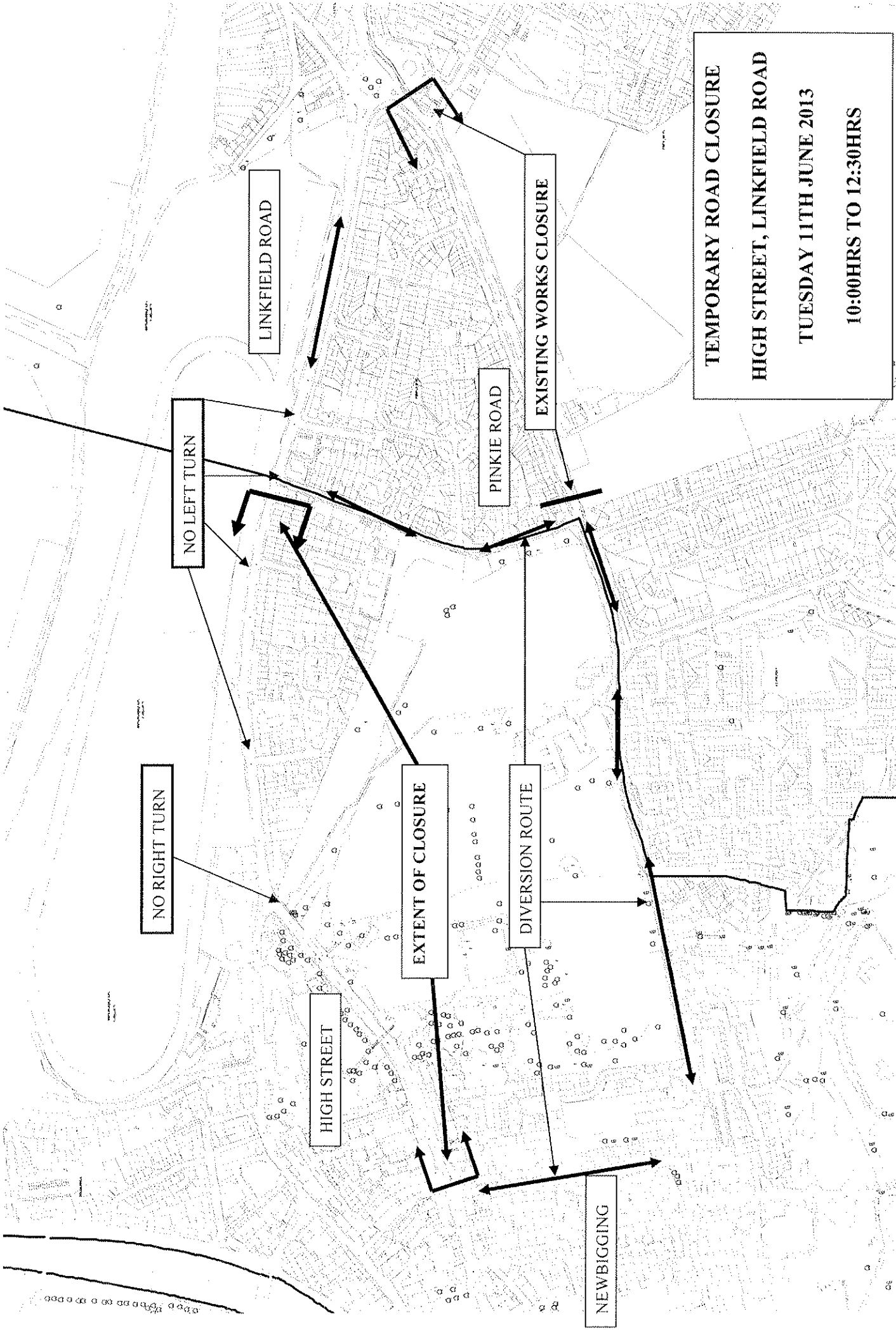

TEMPORARY ROAD CLOSURE
HIGH STREET, LINKFIELD ROAD
TUESDAY 11TH JUNE 2013
10:00HRS TO 12:30HRS

NO RIGHT TURN

NO LEFT TURN

LINKFIELD ROAD

HIGH STREET

EXTENT OF CLOSURE

PINKIE ROAD

DIVERSION ROUTE

EXISTING WORKS CLOSURE

NEWBIGGING

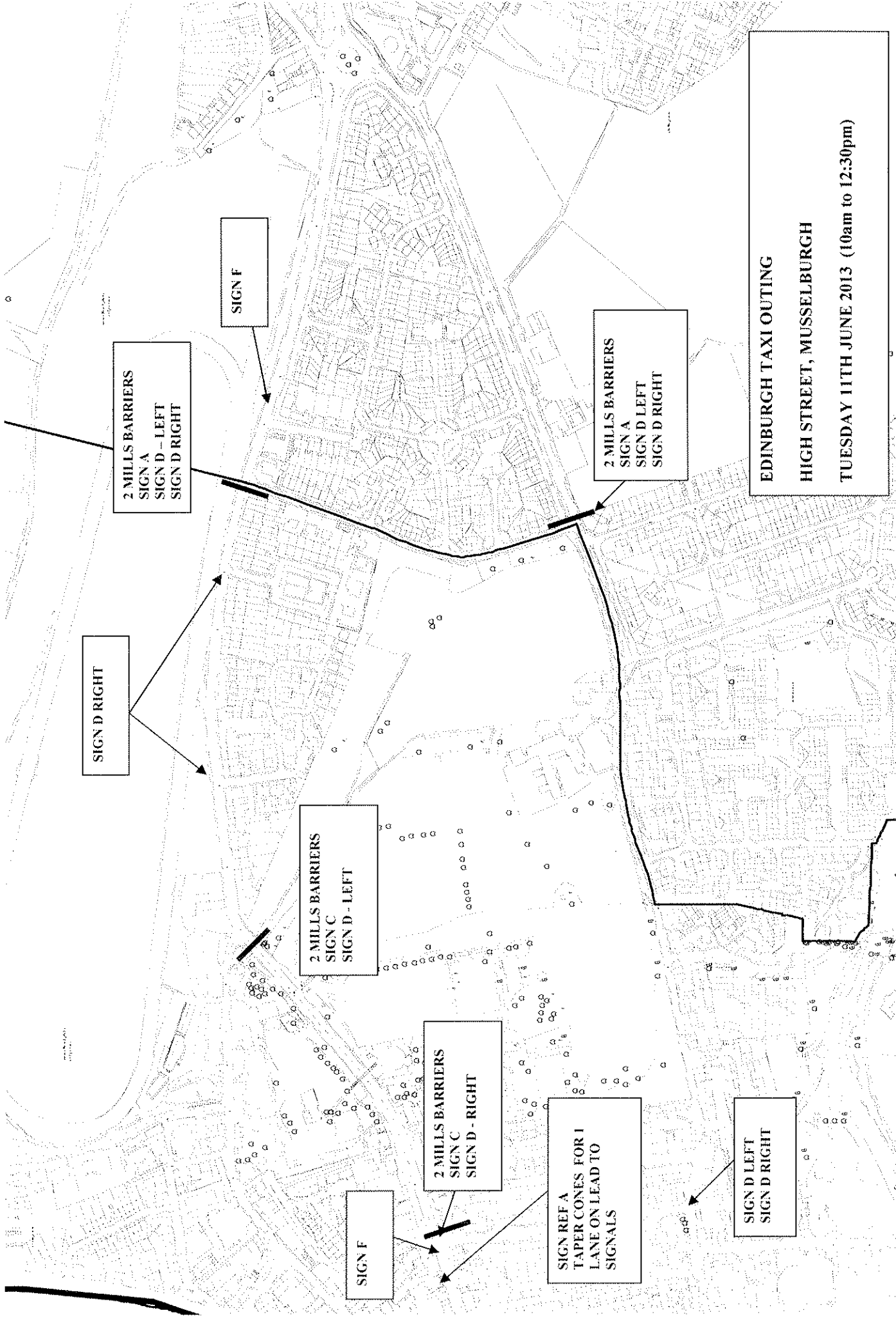

SIGN D RIGHT

2 MILLS BARRIERS
SIGN A
SIGN D - LEFT
SIGN D RIGHT

SIGN F

2 MILLS BARRIERS
SIGN C
SIGN D - LEFT

2 MILLS BARRIERS
SIGN C
SIGN D - RIGHT

SIGN F

SIGN REF A
TAPER CONES FOR 1
LANE ON LEAD TO
SIGNALS

SIGN D LEFT
SIGN D RIGHT

2 MILLS BARRIERS
SIGN A
SIGN D LEFT
SIGN D RIGHT

EDINBURGH TAXI OUTING
HIGH STREET, MUSSELBURGH
TUESDAY 11TH JUNE 2013 (10am to 12:30pm)