

Signed: *D. McKelvey*
Dated: 12/19/19

STEWARTON (SHEET 2 OF 3)



AyrshireRoadsAlliance

A partnership between East Ayrshire Council and South Ayrshire Council

Head of Roads - Ayrshire Roads Alliance
Stewart Turner
BSc(Hons), MSc, CEng, MICE, MCHT
Opera House, 8 John Finnie Street
Kilmarnock, KA1 1DD



PLAN REF
39A

EAST AYRSHIRE COUNCIL
(Various Roads within East Ayrshire)
(Waiting and Loading Restrictions
and Designated Parking Places)
(Amendments)
Order 2019

Scale 1:1250 Date 3/9/19
Drawing prepared at:
Opera House, 8 John Finnie Street,
Kilmarnock KA1 1DD

KEY

Existing restrictions:

-  NO WAITING AT ANY TIME
-  NO LOADING AT ANY TIME
-  NO WAITING AT ANY TIME



LIMITED WAITING
MONDAY TO FRIDAY 9:00am TO 5:00pm
SATURDAY 9:00am TO 1:00pm
MAX STAY 1 HOUR
RETURN 1 HOUR

NEW RESTRICTIONS:

-  NO WAITING AT ANY TIME
-  NO LOADING AT ANY TIME

Reproduced from the Ordnance Survey Mapping with the permission of the controller of Her Majesty's Stationery Office. © Crown Copyright. Unauthorised reproduction infringes Crown Copyright and may lead to prosecution or civil proceedings. East Ayrshire Council SLA Licence Number: 100023409

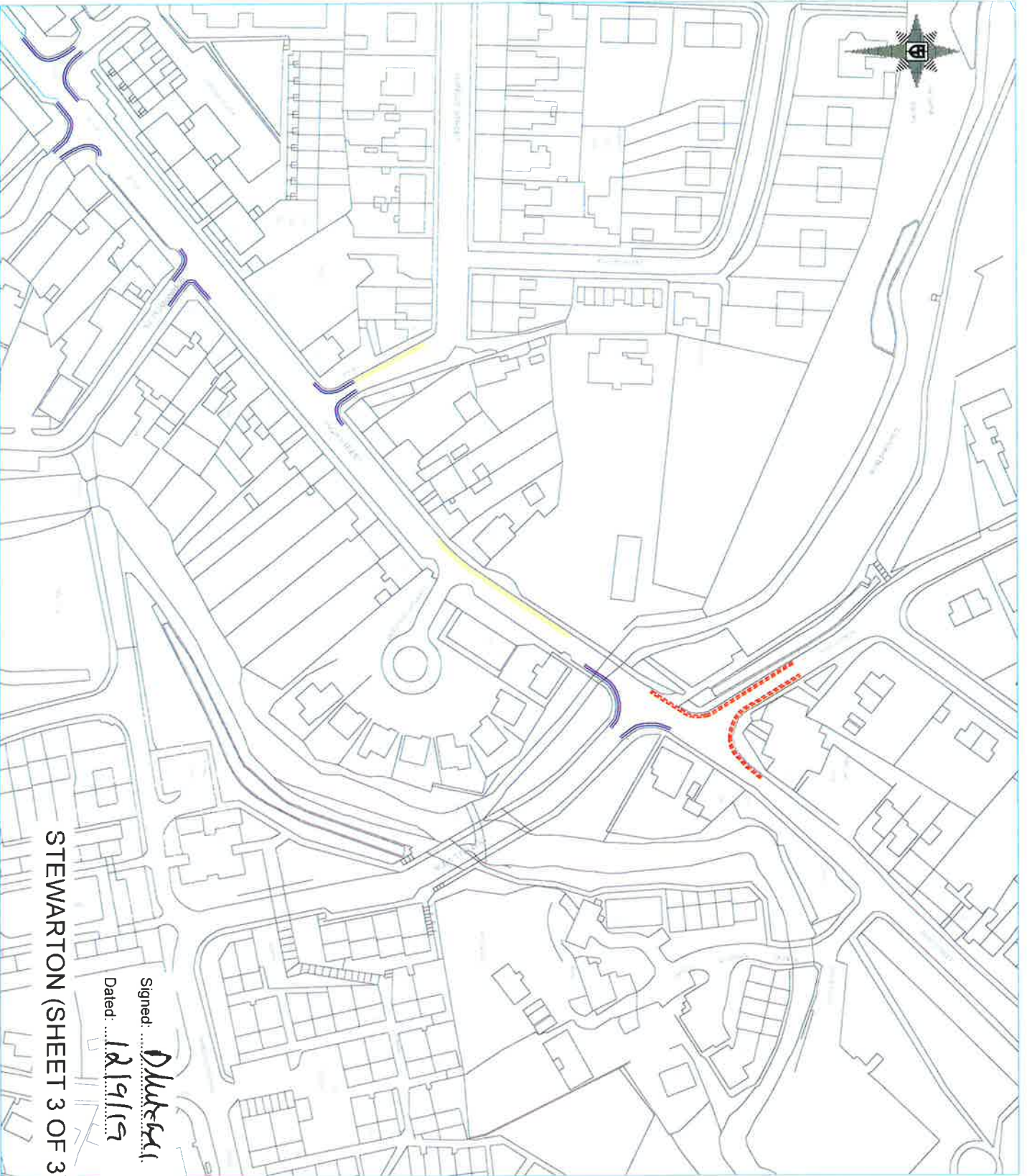

STEWARTARTON (SHEET 3 OF 3)

Signed: *D. Hulse*
 Dated: 12/19/19



Ayrshire Roads Alliance
 A partnership between East Ayrshire Council and South Ayrshire Council

Head of Roads - Ayrshire Roads Alliance
Stewart Turner
 BSc(Hons), MSc, CEng, MICE, MCHIT
 Opera House, 8 John Finnie Street
 Kilmarnock, KA1 1DD

PLAN REF
40

EAST AYRSHIRE COUNCIL
 (Various Roads within East Ayrshire)
 (Waiting and Loading Restrictions
 and Designated Parking Places)
 (Amendments)
 Order 2019

Scale: 1:1250 Date: 3/9/19
 Drawing prepared at
 Opera House, 8 John Finnie Street,
 Kilmarnock KA1 1DD

- KEY**
- EXISTING RESTRICTIONS**
 - NO WAITING AT ANY TIME
 - NO LOADING AT ANY TIME
 - NO WAITING AT ANY TIME
 - NEW RESTRICTIONS**
 - NO WAITING AT ANY TIME

Reproduced from the Ordnance Survey Mapping with the permission of the Controller of Her Majesty's Stationery Office, © Crown Copyright. Unauthorised reproduction infringes Crown Copyright and may lead to prosecution or civil proceedings. East Ayrshire Council SLA Licence Number: 100029409



Signed: *D. M. K. S. (1)*
 Dated: 12/9/19

FENWICK



A partnership between East Ayrshire Council and South Ayrshire Council

Head of Roads - Ayrshire Roads Alliance

Stewart Turner

BSc(Hons), MSc, CEng, MICE MCHT
 Opera House, 8 John Finnie Street
 Kilmarnock, KA1 1DD

PLAN REF

46

EAST AYRSHIRE COUNCIL





(Various Roads within East Ayrshire)
 (Waiting and Loading Restrictions
 and Designated Parking Places)
 (Amendments)

Order 2019

Scale: 1:1250 Date: 3/9/19
 Drawing prepared at:
 Opera House, 8 John Finnie Street,
 Kilmarnock, KA1 1DD

KEY

AMENDMENTS:

-  REMOVE DESIGNATED DISABLED PERSONS PARKING
-  MONDAY TO FRIDAY 9.00am - 5.00pm
-  MAX STAY 2 HOURS
-  NO RETURN 1 HOUR

Reproduced from the Ordnance Survey Mapping with the permission of the Controller of Her Majesty's Stationery Office, © Crown Copyright. Unauthorised use of this information is prohibited and may lead to prosecution of civil proceedings. East Ayrshire Council SIA Licence Number: 100023408.



Signed: *Stewart Turner*

Dated: 12/19/19

KILMARNOCK



Ayrshire Roads Alliance
A partnership between East Ayrshire Council and South Ayrshire Council

Head of Roads - Ayrshire Roads Alliance
Stewart Turner
Bechtors, MSc, CEng, MICE, MCHT
Opera House, 8 John Fienne Street
Kilmarnock, KA1 1DD

PLAN REF
48

EAST AYRSHIRE COUNCIL
(Various Roads within East Ayrshire)
(Waiting and Loading Restrictions and Designated Parking Places) (Amendments)
Order 2019

Scale 1:1250 Date 3/9/19
Drawing prepared at:
Opera House, 8 John Fienne Street,
Kilmarnock, KA1 1DD

KEY

NEW RESTRICTIONS:
----- NO WAITING AT ANY TIME

Reproduced from the Ordnance Survey Mapping with the permission of the Controller of Her Majesty's Stationery Office. © Crown Copyright. Unauthorised reproduction infringes Crown Copyright and may lead to prosecution. Ordnance Survey, East Ayrshire Council S.U.A. Licence Number: 100023408



A partnership between East Ayrshire Council and South Ayrshire Council

Head of Roads - Ayrshire Roads Alliance
Stewart Turner
 BSc(Hons), MSc, CEng, MICE, MCHT
 Opera House, 8 John Finnie Street
 Kilmarnock, KA1 1DD

PLAN REF
49

EAST AYRSHIRE COUNCIL
 (Various Roads within East Ayrshire)
 (Waiting and Loading Restrictions
 and Designated Parking Places)
 (Amendments)
 Order 2019

Scale: 1:1250 Date: 3/9/19
 Drawing prepared at:
 Opera House, 8 John Finnie Street,
 Kilmarnock, KA1 1DD

KEY

NEW RESTRICTIONS:
 NO WAITING AND NO
 LOADING AT ANY TIME

Reproduced from the Ordnance Survey Mapping with
 the permission of the Controller of Her Majesty's
 Stationery Office, © Crown Copyright
 Ordnance Survey. All rights reserved. Ordnance
 Survey may be used to prosecute or civil proceedings
 East Ayrshire Council SIA Licence Number
 100023409

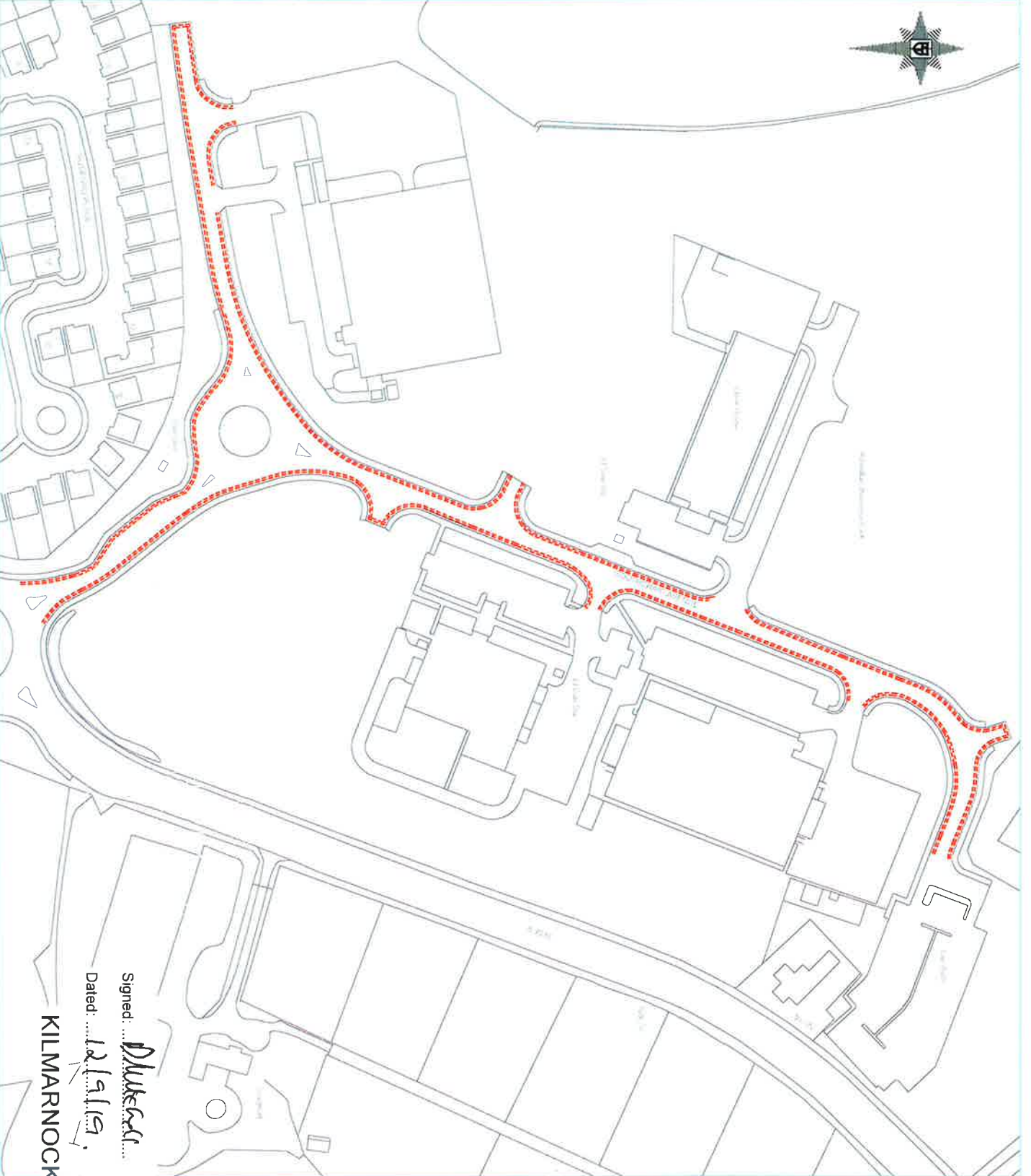

Signed: *Stewart Turner*
Dated: 12/19/19

KILMARNOCK



Ayrshire Roads Alliance
A partnership between East Ayrshire Council and South Ayrshire Council.

Head of Roads - Ayrshire Roads Alliance
Stewart Turner
BSc(Hons), MSc, CEng, MICE, MCHIT
Opera House, 8 John Finnie Street
Kilmarnock, KA1 1DD

PLAN REF
51

EAST AYRSHIRE COUNCIL
(Various Roads within East Ayrshire)
(Waiting and Loading Restrictions
and Designated Parking Places)
(Amendments)
Order 2019

Scale 1:1250 Date 3/9/19
Drawing prepared at:
Opera House, 8 John Finnie Street,
Kilmarnock KA1 1DD

KEY

NEW RESTRICTIONS:

----- NO WAITING AT ANY TIME

Reproduced from the Ordnance Survey Mapping with the permission of the Controller of Her Majesty's Stationery Office. Unauthorised reproduction infringes Crown Copyright and may lead to prosecution or civil proceedings. East Ayrshire Council SLA Licence Number: 100023409