

CLASSIFICATION - Baseline (Low Risk)
 0 10 100
 Millimetres

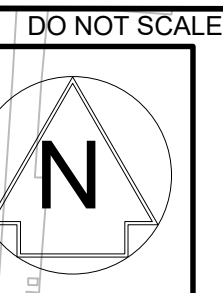

- Notes:
1. Dimensions are in meters unless otherwise stated.
 2. Draft outline for comments.
 3. Existing parking provision extents and dimensions assumed due to worn road markings.

- Key
- Traffic Signal
 - K1 - Bull Nose Kerb
 - K2 - Half Batter Kerb
 - K2D - Transition Kerb
 - Visibility Checked At 50m From Stop Line
 - Existing Markings
 - Proposed Markings
 - Existing Bus Stop Markings
 - Existing Guardrail

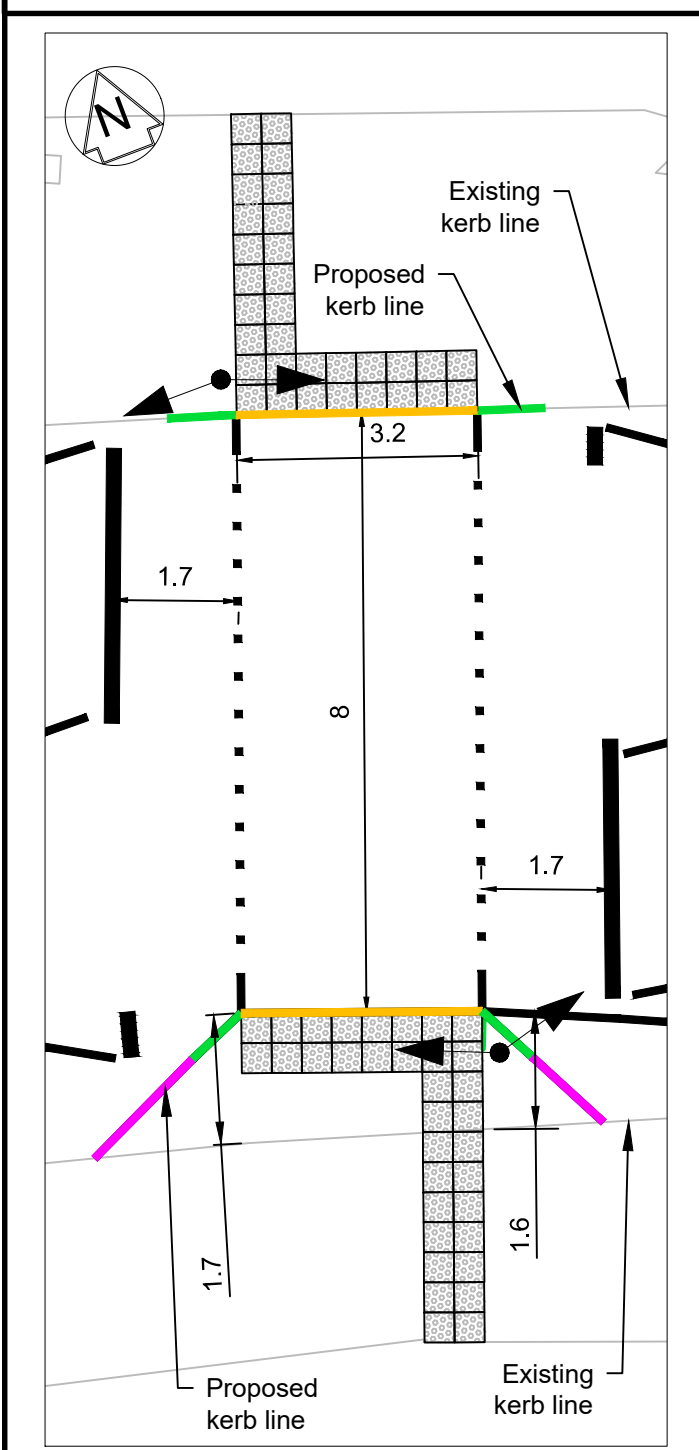

INSET
SCALE 1:100

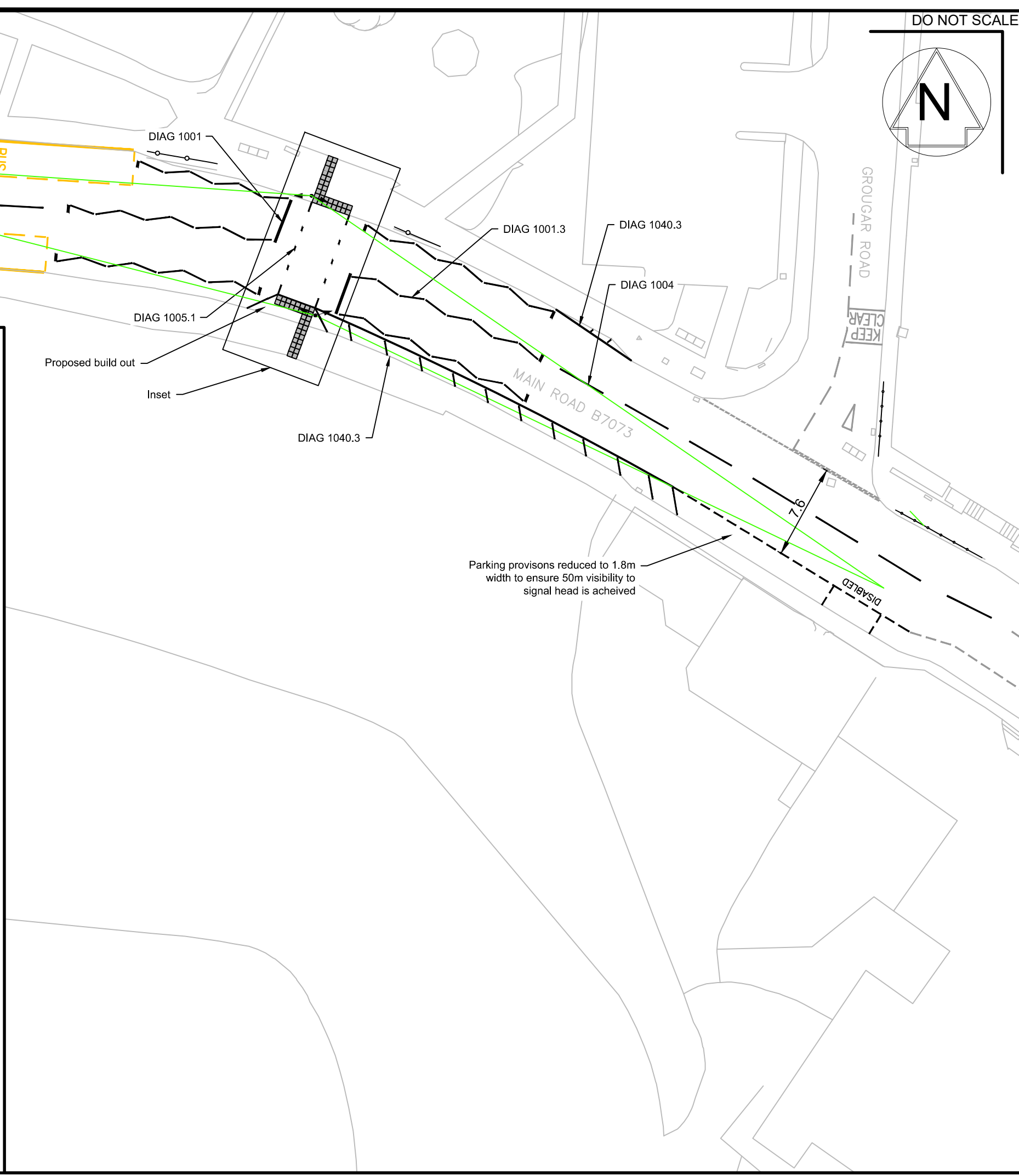

Rev.	Date	Description	By	Chk'd	App'd
P01	15/10/19	FIRST ISSUE	MG	JM	KA

FOR PUBLIC ADVERT N/A

SNC-LAVALIN
 200 Broomielaw
 Glasgow
 G1 4RU
 Tel: +44 (0)1412 202000
 Fax: +44 (0)1412 202001
 www.atkinsglobal.com
 Member of the SNC-Lavalin Group



Project Title
TRAFFIC PROJECTS 2018

Drawing Title
**PROPOSED PUFFIN CROSSING
 MAIN ROAD B7073, CROOKEDHOLM**

Scale	Designed	Drawn	Checked	Authorised
NTS	JM	MG	JM	KA
Original Size	Date	Date	Date	Date
A3	15/10/19	15/10/19	15/10/19	15/10/19
Drawing Number	Revision			
5182115-ATK-DRG-HW-00012	P01			

Internal Project Number: 5182115