

NOTES:

Proposal to extend existing double red lines 36.6m north on the northbound carriageway bus lane on Lothian Road. This is to allow a new 39m bus stop cage to be implemented with no loading at any times restrictions applied.

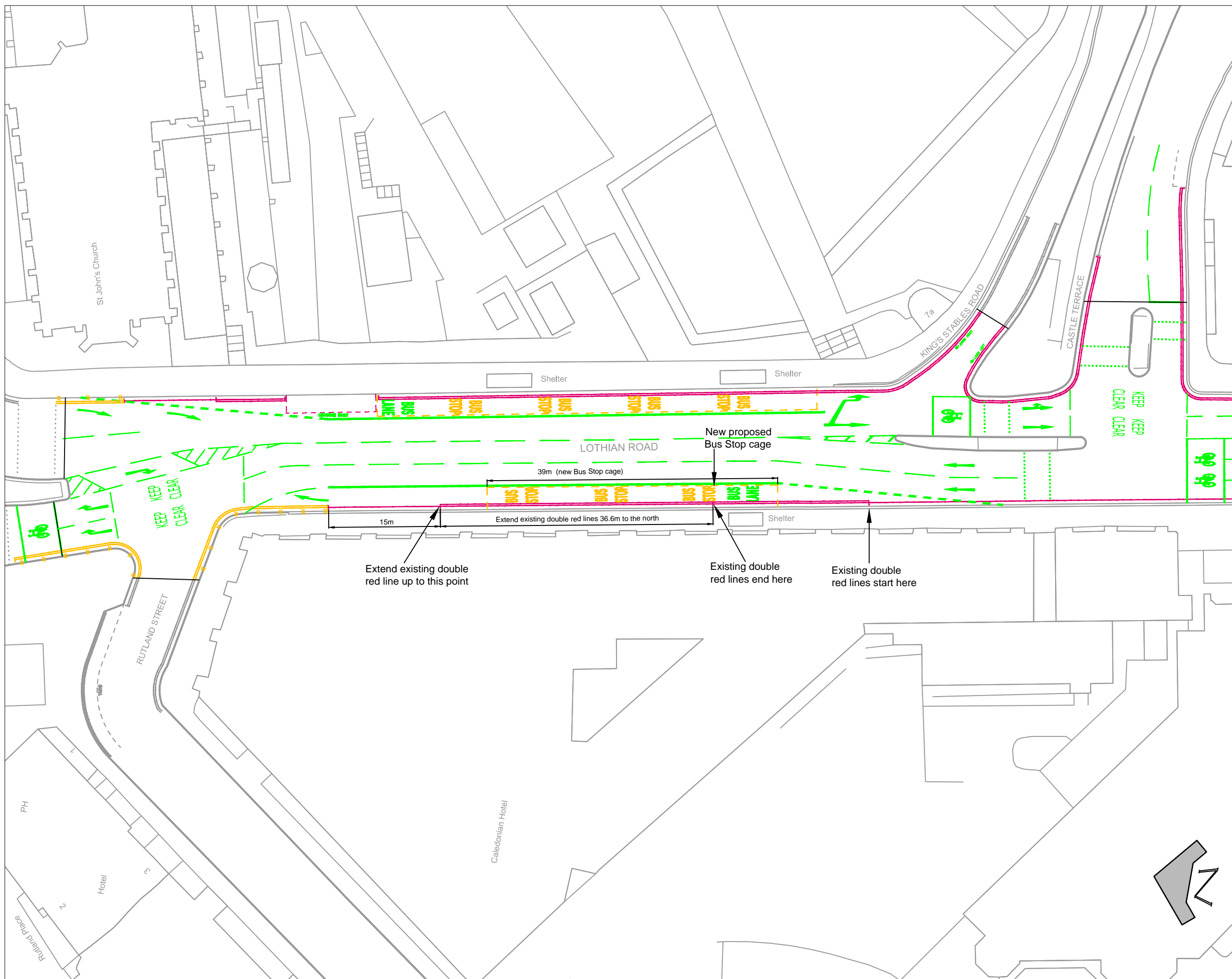

This map is reproduced from Ordnance Survey material with the permission of Ordnance Survey on behalf of the Controller of Her Majesty's Stationery Office © Crown copyright. Unauthorised reproduction infringes Crown copyright and may lead to prosecution or civil proceedings.
100023420 (2019)

| | | | | |
|-----|---------|----|------|-------|
| REV | DETAILS | BY | DATE | CHECK |
| | | | | |

EDINBURGH
THE CITY OF EDINBURGH COUNCIL

The City of Edinburgh Council
Waverley Court
4 East Market Street
Edinburgh, EH8 8BG
Telephone: 0131 200 2000

PLACE MANAGEMENT
IN INFRASTRUCTURE
TRANSPORT DESIGN AND DELIVERY

LOTHIAN ROAD
ROAD MARKING TRO
SINGLE RED TO DOUBLE RED LINES

Date: 23-01-2019
Scale: 1/500
Job No: 636895
Drawn by: WOK
Checked by: RIP

Drawing Name: G:\SICITransport Design & Delivery\TDD\636895\Lothian Road\CAD\2 Series\TDD-636895-3-1200 Road Markings - TRO BUS STOPS.dwg
Xrefs: G:\SICITransport Design & Delivery\TDD\636895\Lothian Road\CAD\1 refs\OS Map Lothian Road
Xrefs: G:\SICITransport Design & Delivery\TDD\636895\Lothian Road\CAD\1 refs\DES Lothian Road - Road Markings.rvt
Xrefs: G:\SICITransport Design & Delivery\TDD\636895\Lothian Road\CAD\1 refs\DES Lothian Road - Road Markings.rvt
Xrefs: G:\SICITransport Design & Delivery\TDD\636895\Lothian Road\CAD\1 refs\DES Lothian Road - Road Markings.rvt