

RSO-002  
RSO-001

RSO-002  
RSO-001



**KEY**  
Existing carriageway redetermined as footway  
(A, B)

HAYMARKET TERRACE

ROSEBERRY CRESCENT

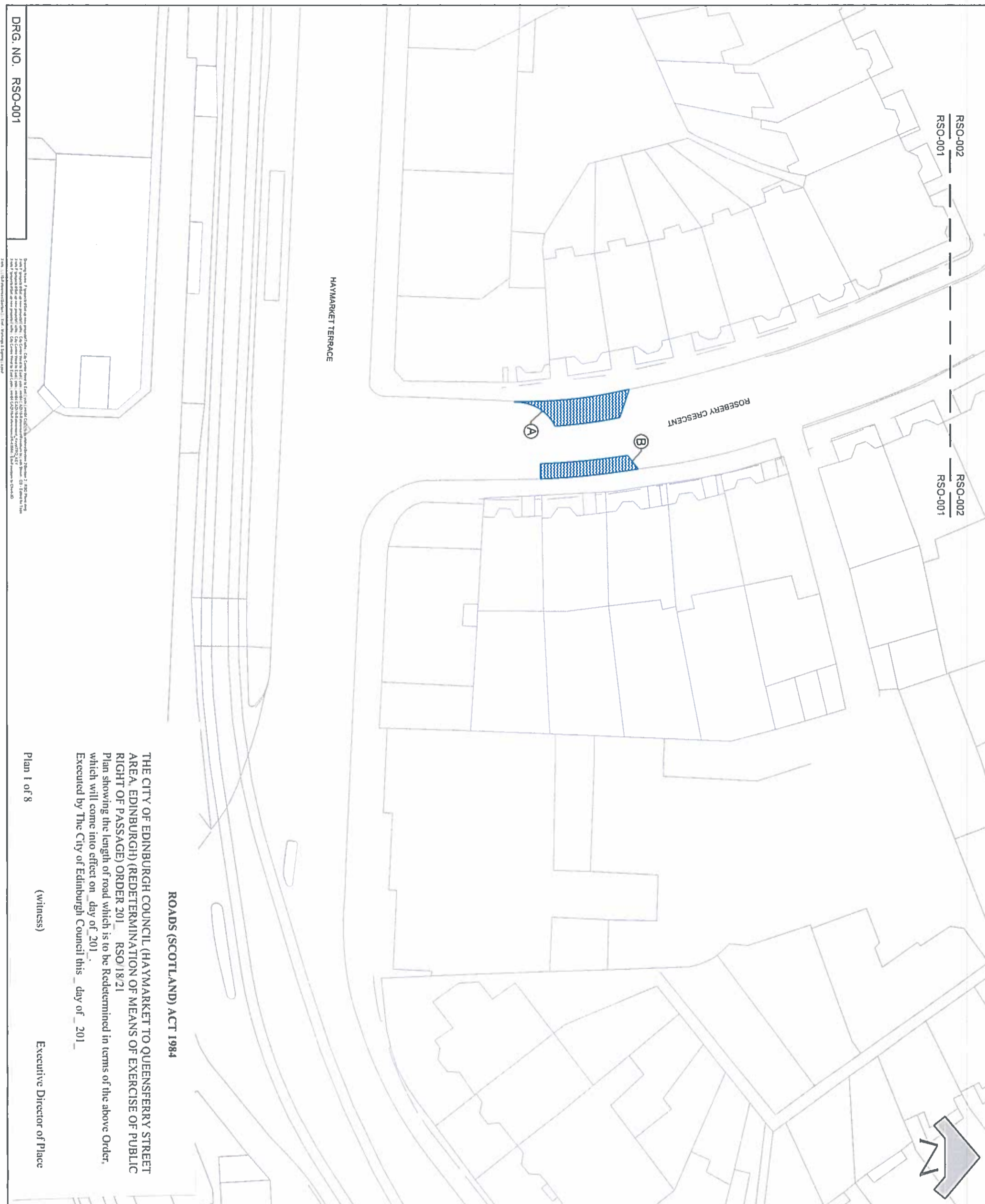
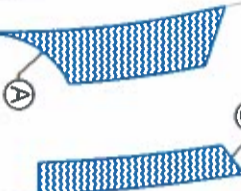

**ROADS (SCOTLAND) ACT 1984**

THE CITY OF EDINBURGH COUNCIL (HAYMARKET TO QUEENSFERRY STREET AREA, EDINBURGH) (REDETERMINATION OF MEANS OF EXERCISE OF PUBLIC RIGHT OF PASSAGE) ORDER 201 RSO/18/21

Plan showing the length of road which is to be Redetermined in terms of the above Order, which will come into effect on day of 201, Executed by The City of Edinburgh Council this day of 201.

(witness) Executive Director of Place

Plan 1 of 8

Edinburgh City Council Planning and Transport Department  
4 East Market Street  
Edinburgh, EH8 8EG  
Telephone: 0131 200 2000

This plan is reproduced from Ordnance Survey material with the permission of Ordnance Survey on behalf of the Controller of Her Majesty's Stationery Office © Crown copyright. Unauthorised reproduction infringes Crown copyright and may lead to prosecution or civil proceedings.  
10002320 (2017)

2	CLIENT COMMENTS	JN	01/02/19	PM	
1	CLIENT COMMENTS	JN	03/09/18	PM	
REV	DETAILS	BY	DATE	CHECK	

**EDINBURGH**  
THE CITY OF EDINBURGH COUNCIL

The City of Edinburgh Council  
Waverley Court  
4 East Market Street  
Edinburgh, EH8 8EG  
Telephone: 0131 200 2000

PLANNING AND TRANSPORT  
INFRASTRUCTURE  
TRANSPORT DESIGN & DELIVERY  
CITY CENTRE WEST TO EAST  
CYCLE LINK  
RE-DETERMINATION  
SECTION 2 - SHEET 1 OF 8

NOTES:

- KEY**
- Existing carriageway redetermined as footway (C D E)

This map is reproduced from Ordnance Survey material with the permission of Ordnance Survey on behalf of the Controller of Her Majesty's Stationery Office © Crown copyright. Unauthorised reproduction infringes Crown copyright and may lead to prosecution or civil proceedings.

10002320 (2017)

REV	DETAILS	BY	DATE	CHKD
1	CLIENT COMMENTS	JN	03/09/18	PM

# EDINBURGH

THE CITY OF EDINBURGH COUNCIL

The City of Edinburgh Council  
 Waverley Court  
 4 East Market Street  
 Edinburgh EH8 8EG  
 Telephone 0131 200 2000

PLACE  
 PLANNING AND TRANSPORT  
 INFRASTRUCTURE  
 TRANSPORT DESIGN & DELIVERY

CITY CENTRE WEST TO EAST  
 CYCLE LINK  
 RE-DETERMINATION  
 SECTION 2 - SHEET 2 OF 8

Date: 03/09/18  
 Scale: 1:500 @ A3  
 Drawn by: AP  
 Checked by: MP  
 Approved by: PM

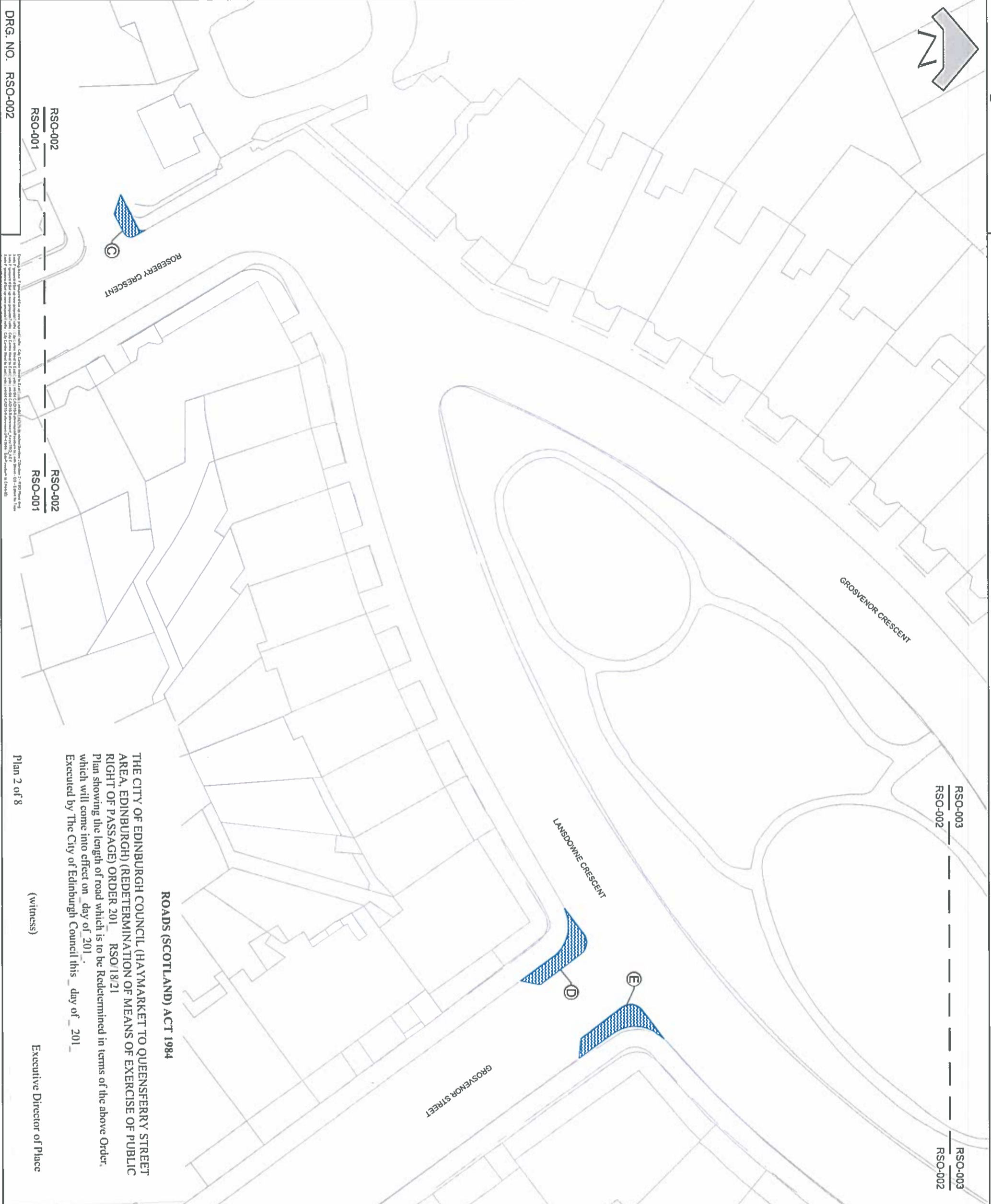

RSO-003  
 RSO-002  
 RSO-003  
 RSO-002

GROSVENOR CRESCENT

LANSDOWNE CRESCENT

GROSVENOR STREET

ROSEBERY CRESCENT

ROADS (SCOTLAND) ACT 1984

THE CITY OF EDINBURGH COUNCIL (HAYMARKET TO QUEENSFERRY STREET AREA, EDINBURGH) (RE-DETERMINATION OF MEANS OF EXERCISE OF PUBLIC RIGHT OF PASSAGE) ORDER 201 RSO/18/21

Plan showing the length of road which is to be Redetermined in terms of the above Order, which will come into effect on day of 201\_.

Executed by The City of Edinburgh Council this day of 201\_

(witness)

Executive Director of Place

RSO-002

RSO-001

RSO-002

RSO-001

Ordnance Survey: The information on this map is derived from Ordnance Survey data. The City of Edinburgh Council is not responsible for any errors or omissions in this map. The City of Edinburgh Council is not responsible for any loss or damage arising from the use of this map. The City of Edinburgh Council is not responsible for any loss or damage arising from the use of this map. The City of Edinburgh Council is not responsible for any loss or damage arising from the use of this map.



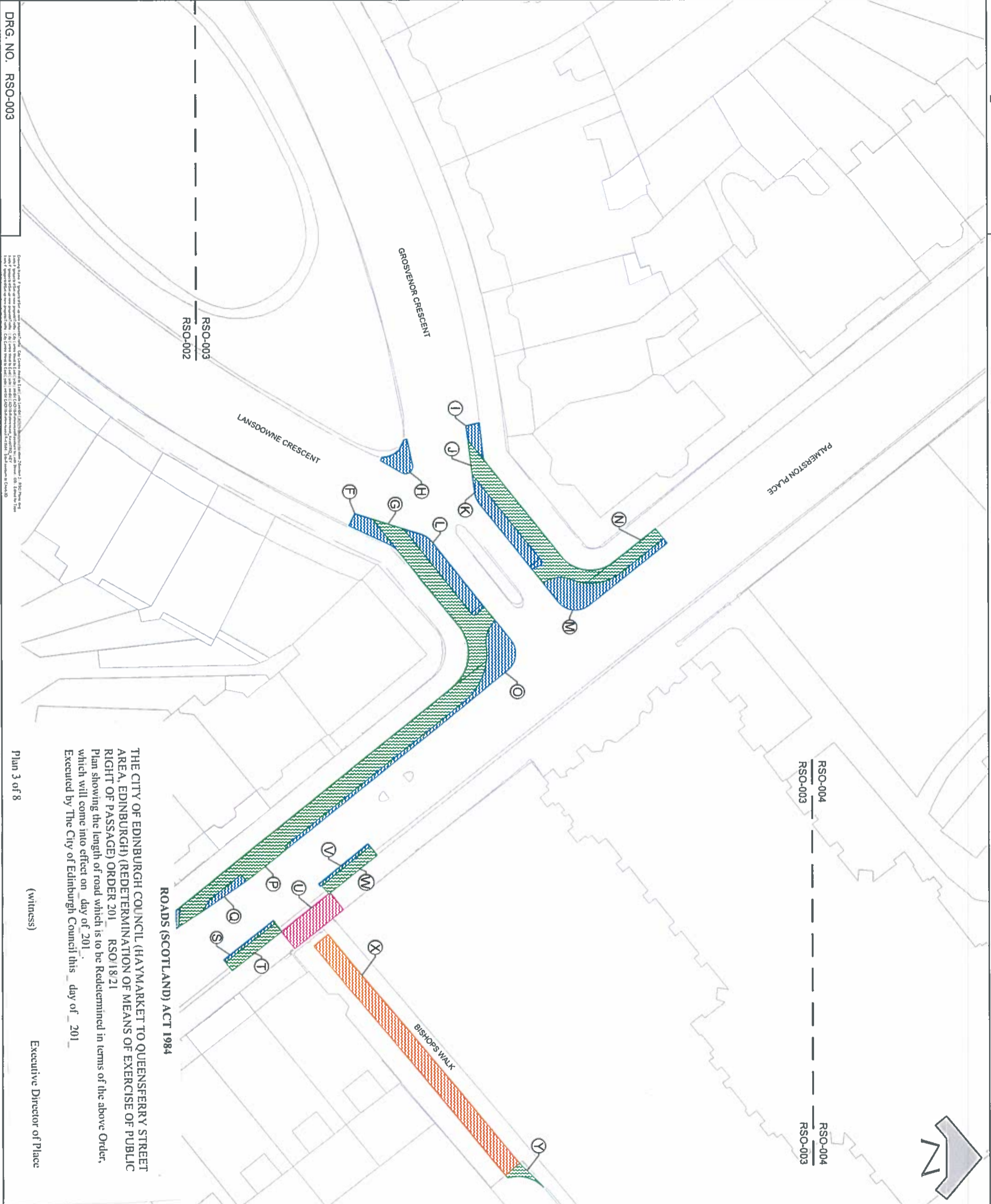

- KEY**
- Existing carriageway redetermined as footway (F, H, I, K, L, M, O, Q, R, S, V)
  - Existing carriageway redetermined as cycletrack (G, J, N, P, T, W, Y)
  - Existing footway redetermined as cycletrack (U)
  - Existing verge redetermined as cycletrack (X)

**NOTES:**

THE CITY OF EDINBURGH COUNCIL (HAYMARKET TO QUEENSFERRY STREET AREA, EDINBURGH) (REDETERMINATION OF MEANS OF EXERCISE OF PUBLIC RIGHT OF PASSAGE) ORDER 201 RSO/18/21  
 Plan showing the length of road which is to be Redetermined in terms of the above Order, which will come into effect on day of 201  
 Executed by The City of Edinburgh Council this day of 201

ROADS (SCOTLAND) ACT 1984

(witness) Executive Director of Place

**EDINBURGH**  
THE CITY OF EDINBURGH COUNCIL

The City of Edinburgh Council  
 Waverley Court  
 4 East Market Street  
 Edinburgh, EH8 8BG  
 Telephone: 0131 200 2000

PLACE  
PLANNING AND TRANSPORT  
INFRASTRUCTURE  
TRANSPORT DESIGN & DELIVERY

**CITY CENTRE WEST TO EAST  
CYCLE LINK  
RE-DETERMINATION  
SECTION 2 - SHEET 3 OF 8**

REV	DETAILS	BY	DATE	CHECK
1	CLIENT COMMENTS	JUN	03/09/18	PM

This map is reproduced from Ordnance Survey material with the permission of Ordnance Survey on behalf of the Controller of Her Majesty's Stationery Office © Crown copyright. Unauthorised reproduction infringes Crown copyright and may lead to prosecution or civil proceedings.  
100023420 (2017)







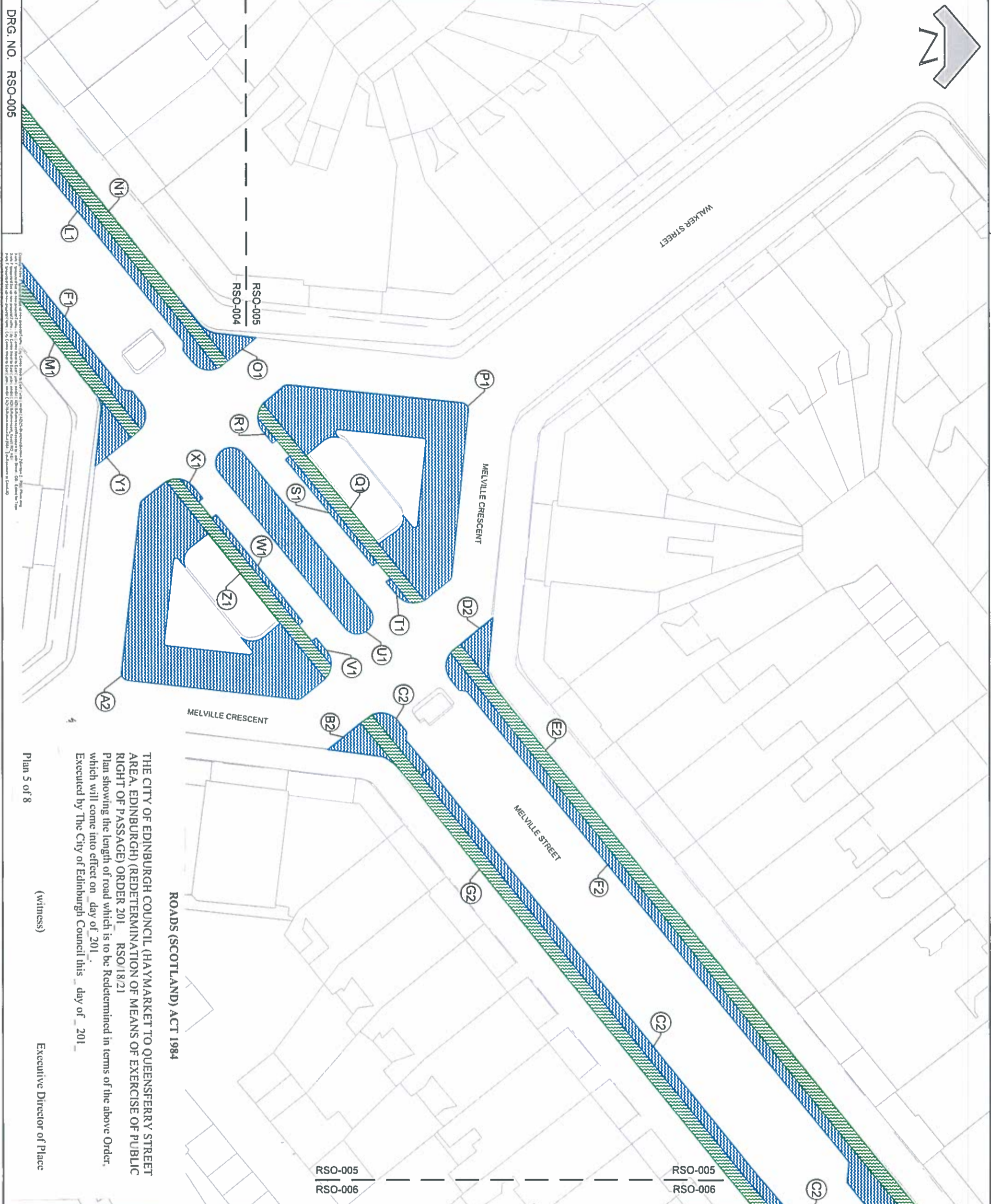

NOTES:

- KEY**
- Existing carriageway redetermined as footway (F1, L1, O1, P1, R1, S1, T1, U1, V1, W1, X1, Y1, A2, B2, C2, D2, F2)
  - Existing carriageway redetermined as cycletrack (M1, N1, O1, Z1, E2, G2)

This map is reproduced from Ordnance Survey material with the permission of Ordnance Survey on behalf of the Controller of Her Majesty's Stationery Office © Crown copyright. Unauthorised reproduction infringes Crown copyright and may lead to prosecution or civil proceedings.  
100023420 (2/11)

REV	DETAILS	BY	DATE	CHECK
2	CLIENT COMMENTS	JIN	05/02/19 PM	
1	CLIENT COMMENTS	JIN	03/09/18 PM	

**EDINBURGH**  
THE CITY OF EDINBURGH COUNCIL

The City of Edinburgh Council  
Waverley Court  
4 East Market Street  
Edinburgh, EH8 8BG  
Telephone: 0131 200 2000

PLACE  
PLANNING AND TRANSPORT  
INFRASTRUCTURE  
TRANSPORT DESIGN & DELIVERY

CITY CENTRE WEST TO EAST  
CYCLE LINK  
RE-DETERMINATION  
SECTION 2 - SHEET 5 OF 8  
DRG. NO. RSO-005

THE CITY OF EDINBURGH COUNCIL (HAYMARKET TO QUEENSFERRY STREET AREA, EDINBURGH) (RE-DETERMINATION OF MEANS OF EXERCISE OF PUBLIC RIGHT OF PASSAGE) ORDER 201 RSO/18/21  
Plan showing the length of road which is to be Redetermined in terms of the above Order, which will come into effect on day of 201.  
Executed by The City of Edinburgh Council this day of 201

Plan 5 of 8  
(witness)  
Executive Director of Place



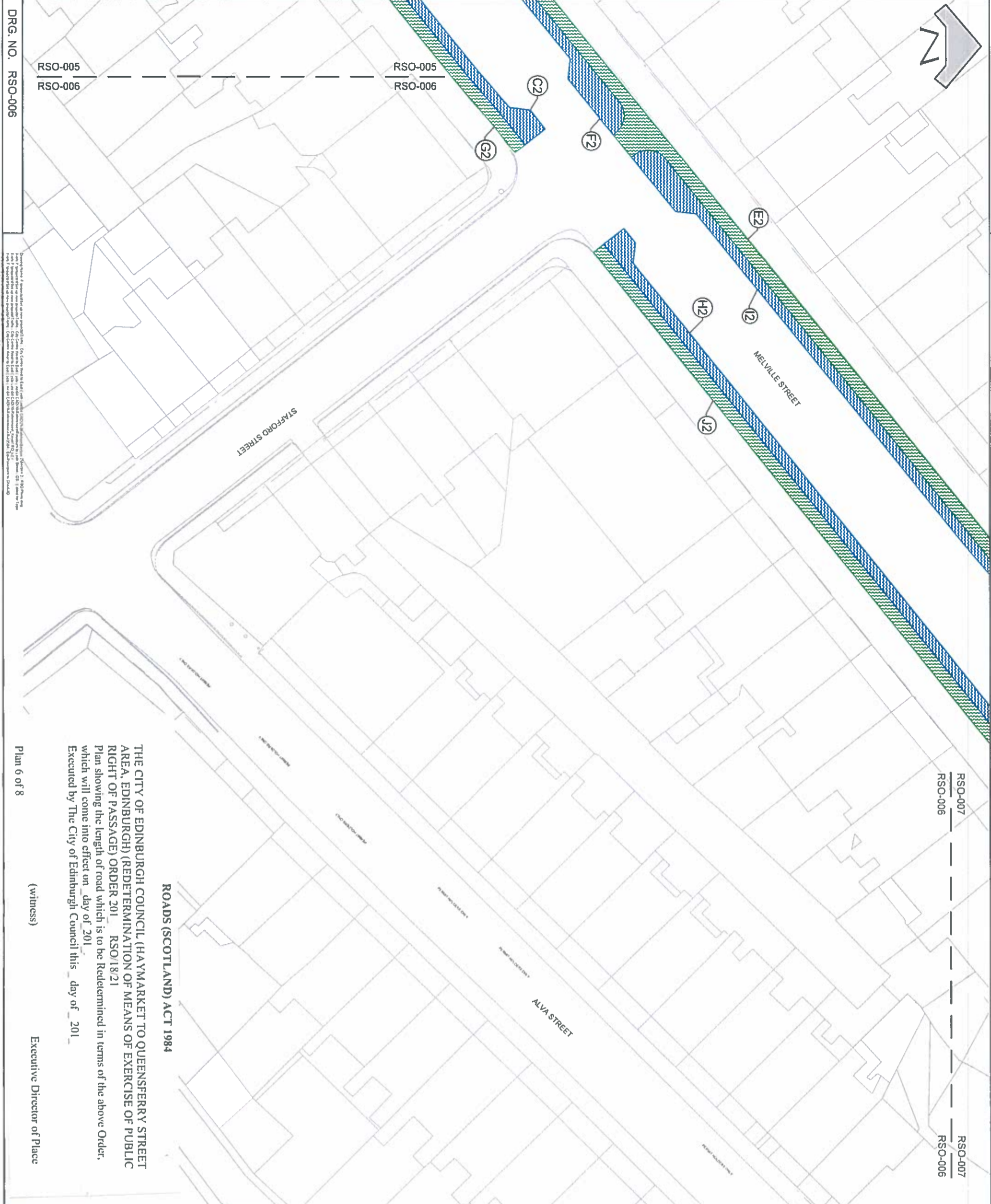

RSO-007  
 RSO-006  
 RSO-007  
 RSO-006

- NOTES:**
- Existing carriageway redetermined as footway (C2, F2, H2, J2)
  - Existing carriageway redetermined as cycletrack (E2, G2, J2)

This map is reproduced from Ordnance Survey material with the permission of Ordnance Survey on behalf of the Controller of Her Majesty's Stationery Office. Crown copyright. Unauthorised reproduction infringes Crown copyright and may lead to prosecution or civil proceedings.  
 1000234201 (2011)

REV	DATE	BY	CHECK
3	JN 05/02/19	JN	PM
2	JN 05/12/18	JN	PM
1	JN 03/09/18	JN	PM

**EDINBURGH**  
 THE CITY OF EDINBURGH COUNCIL

The City of Edinburgh Council  
 Waverley Court  
 4 East Market Street  
 Edinburgh, EH1 8EG  
 Telephone: 0131 200 2000

PLACE  
 PLANNING AND TRANSPORT  
 INFRASTRUCTURE  
 TRANSPORT DESIGN & DELIVERY

CITY CENTRE WEST TO EAST  
 CYCLE LINK  
 RE-DETERMINATION  
 SECTION 2 - SHEET 6 OF 8

THE CITY OF EDINBURGH COUNCIL (HAYMARKET TO QUEENSFERRY STREET AREA, EDINBURGH) (RE-DETERMINATION OF MEANS OF EXERCISE OF PUBLIC RIGHT OF PASSAGE) ORDER 201 RSO/18/21  
 Plan showing the length of road which is to be Redetermined in terms of the above Order, which will come into effect on day of 201  
 Executed by The City of Edinburgh Council this day of 201

Executive Director of Place

Plan 6 of 8

Approved for Issue by the City of Edinburgh Council on 18/02/2019. This plan is subject to the terms and conditions of the City of Edinburgh Council's Planning and Transport Infrastructure Design and Delivery Policy. It is not to be used for any other purpose without the prior written consent of the City of Edinburgh Council. The City of Edinburgh Council is not responsible for any loss or damage arising from the use of this plan. The City of Edinburgh Council is not responsible for any loss or damage arising from the use of this plan. The City of Edinburgh Council is not responsible for any loss or damage arising from the use of this plan.



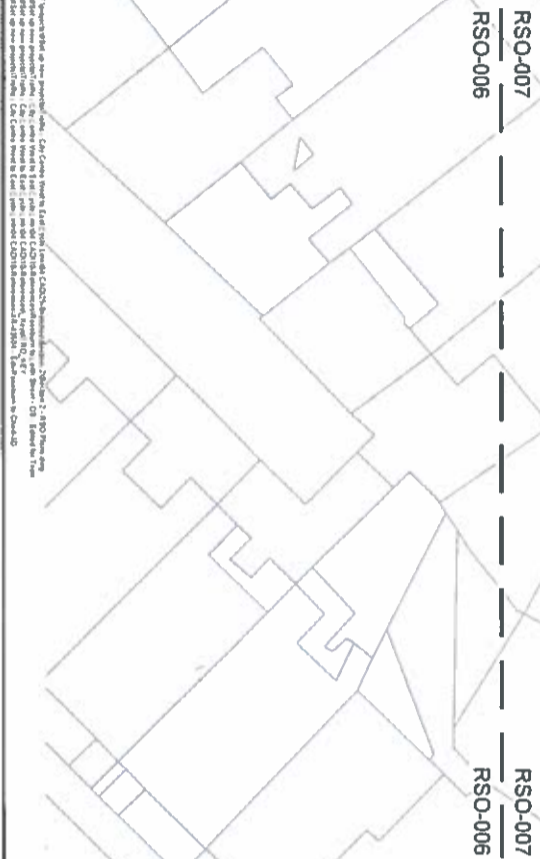
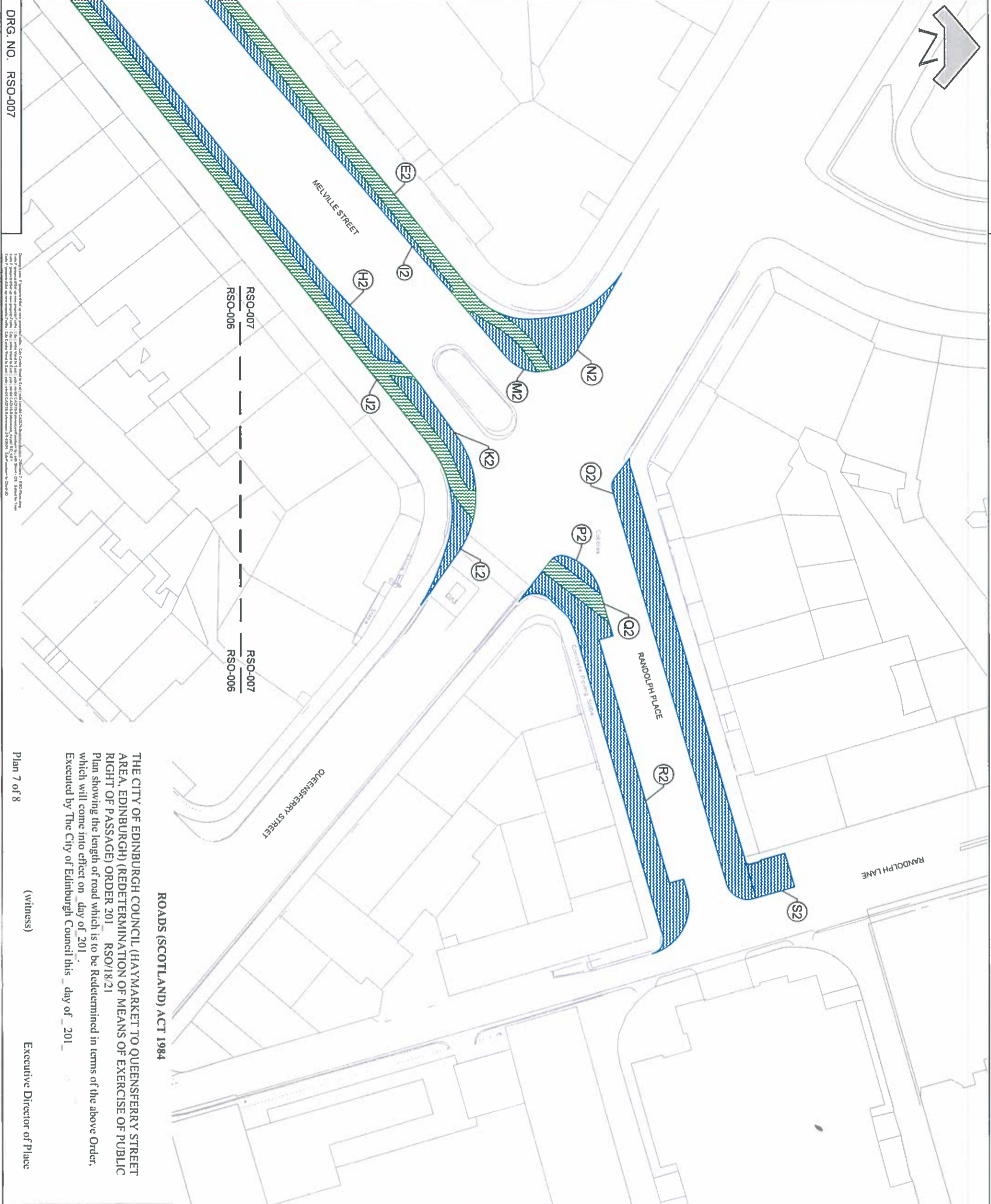

NOTES:

- Existing carriageway redetermined as footway (H2, I2, K2, L2, M2, N2, O2, P2, R2, S2)
- Existing carriageway redetermined as cycletrack (E2, J2, Q2)

This map is reproduced from Ordnance Survey material with the permission of Ordnance Survey on behalf of the Controller of Her Majesty's Stationery Office © Crown copyright. Unauthorised reproduction infringes Crown copyright and may lead to prosecution or civil proceedings.  
100023420 (2017)

NO.	CLIENT COMMENTS	DATE	BY	CHKD.
1		JUN 03/09/18	PM	

**EDINBURGH**  
THE CITY OF EDINBURGH COUNCIL

The City of Edinburgh Council  
Waverley Court  
4 East Market Street  
Edinburgh, EH8 8BG  
Telephone: 0131 220 2000

PLACE  
PLANNING AND TRANSPORT  
INFRASTRUCTURE  
TRANSPORT DESIGN & DELIVERY

CITY CENTRE WEST TO EAST  
CYCLE LINK  
RE-DETERMINATION  
SECTION 2 - SHEET 7 OF 8

ROADS (SCOTLAND) ACT 1984

THE CITY OF EDINBURGH COUNCIL (HAYMARKET TO QUEENSFERRY STREET AREA, EDINBURGH) (RE-DETERMINATION OF MEANS OF EXERCISE OF PUBLIC RIGHT OF PASSAGE) ORDER 201 RSO/18/21  
Plan showing the length of road which is to be Redetermined in terms of the above Order, which will come into effect on day of 201.  
Executed by The City of Edinburgh Council this day of 201

Executive Director of Place

(witness)



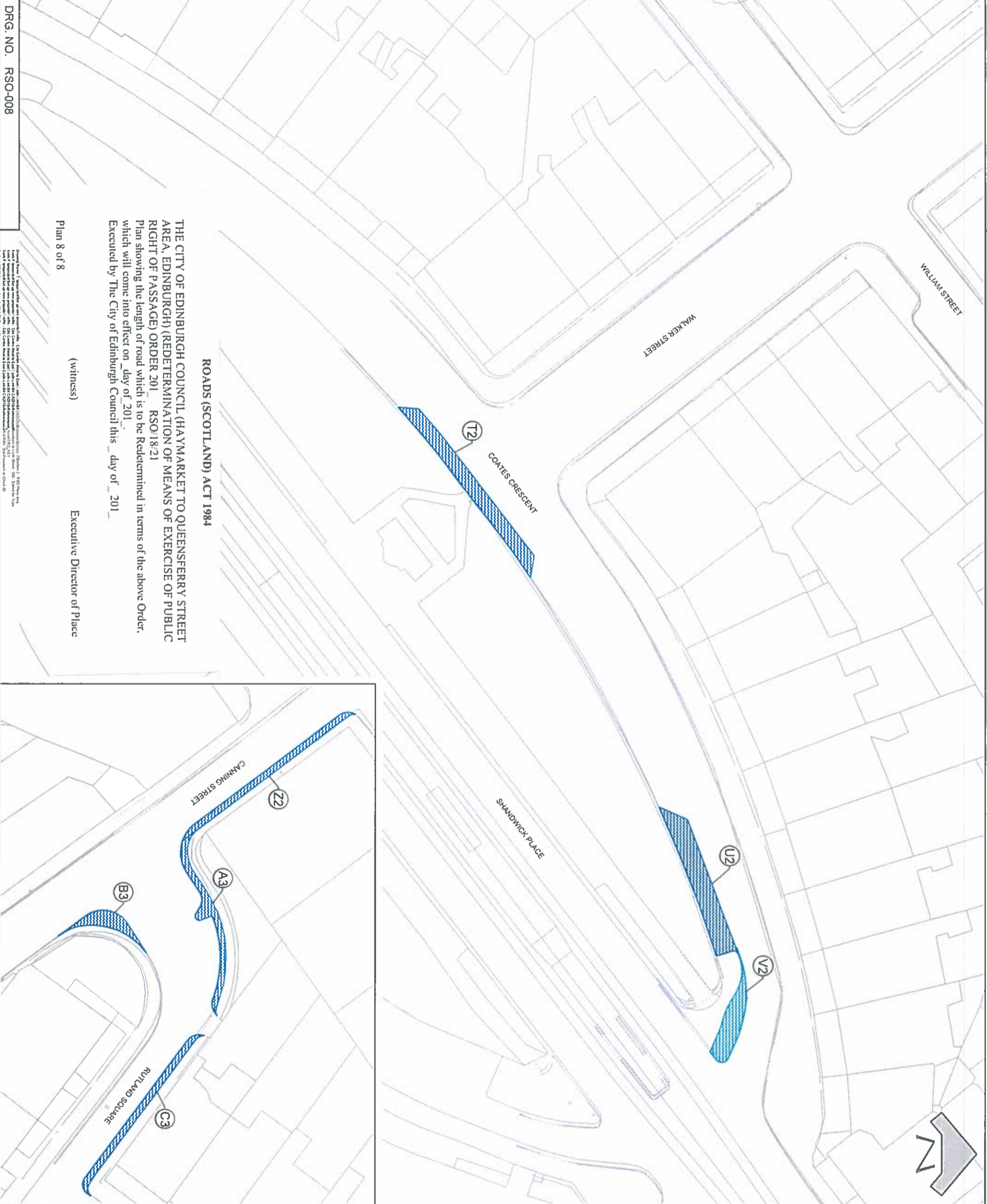

- NOTES:**
- KEY**
- Existing carriageway redetermined as footway (T2, U2, Z2, A3, B3, C3)
  - Existing footway redetermined as carriageway (V2)

**ROADS (SCOTLAND) ACT 1984**

THE CITY OF EDINBURGH COUNCIL (HAYMARKET TO QUEENSFERRY STREET AREA, EDINBURGH) (REDETERMINATION OF MEANS OF EXERCISE OF PUBLIC RIGHT OF PASSAGE) ORDER 201 RSO/18/21

Plan showing the length of road which is to be Redetermined in terms of the above Order, which will come into effect on \_day of \_201\_.

Executed by The City of Edinburgh Council this \_day of \_201\_

(witness)

Plan 8 of 8

Executive Director of Place

This map is reproduced from Ordnance Survey material with the permission of Ordnance Survey on behalf of the Controller of Her Majesty's Stationery Office. Crown copyright. Unauthorised reproduction infringes Crown copyright and may lead to prosecution or civil proceedings.

100023420 (2017)

REV	DATE	BY	CHECK
2		JN	01/02/19 PM
1		JN	03/09/18 PM

**EDINBURGH**

THE CITY OF EDINBURGH COUNCIL

The City of Edinburgh Council  
 Waverley Court  
 4 East Market Street  
 Edinburgh, EH8 8BG  
 Telephone: 0131 206 2000

PLACE  
 PLANNING AND TRANSPORT  
 INFRASTRUCTURE  
 TRANSPORT DESIGN & DELIVERY

CITY CENTRE WEST TO EAST  
 CYCLE LINK  
 RE-DETERMINATION  
 SECTION 2 - SHEET 8 OF 8

Date: AUG 2018  
 Scale: 1:500 @ A3  
 Drawn by: JN  
 Checked by: JN